

SHEET LOCATION MAP (NOT TO SCALE)

DEDICATION

KNOW ALL MEN BY THESE PRESENTS THAT TAYLOR WOODROW COMMUNITIES AT MIRASOL, LTD., A FLORIDA LIMITED PARTNERSHIP, LICENSED TO DO BUSINESS IN FLORIDA, OWNER OF THE LAND SHOWN HEREON, BEING IN SECTIONS 4 AND 5, TOWNSHIP 42 SOUTH, RANGE 42 EAST, CITY OF PALM BEACH GARDENS, PALM BEACH COUNTY, FLORIDA AND BEING PART OF GOLF DIGEST P.C.D., AND SHOWN HEREON AS "MIRASOL PARCEL FOUR", BEING MORE PARTICULARLY DESCRIBED AS FOLLOWS:

A PARCEL OF LAND SITUATE IN SECTIONS 4 AND 5, TOWNSHIP 42 SOUTH, RANGE 42 EAST, PALM BEACH COUNTY, FLORIDA BEING MORE PARTICULARLY DESCRIBED AS FOLLOWS:

COMMENCING AT THE SOUTHWEST CORNER OF SAID SECTION 4; THENCE NORTH 01°54'07" EAST, ALONG THE WEST LINE OF SAID SECTION 4, A DISTANCE OF 945.72 FEET; THENCE SOUTH 88°05'53" EAST, DEPARTING SAID WEST LINE, A DISTANCE OF 83.09 FEET TO THE POINT OF BEGINNING; THENCE NORTH 18°48'50" WEST, A DISTANCE OF 147.50 FEET; THENCE NORTH 06°52'36" WEST, A DISTANCE OF 51.26 FEET; THENCE NORTH 18°45'50" WEST, A DISTANCE OF 198.00 FEET; THENCE NORTH 73°14'10" EAST, A DISTANCE OF 336.71 FEET TO THE POINT OF CURVATURE OF A CURVE CONCAVE TO THE NORTHWEST HAVING A RADIUS OF 1000.00 FEET; THENCE EASTERLY ALONG THE ARC OF SAID CURVE THROUGH A CENTRAL ANGLE OF 28°40'35" AN ARC DISTANCE OF 485.59 FEET TO THE POINT OF TANGENCY; THENCE NORTH 48°33'33" EAST, A DISTANCE OF 224.75 FEET TO THE POINT OF CURVATURE OF A CURVE CONCAVE TO THE SOUTHWEST HAVING A RADIUS OF 565.00 FEET; THENCE NORTHEASTERLY ALONG THE ARC OF SAID CURVE THROUGH A CENTRAL ANGLE OF 31°22'28" AN ARC DISTANCE OF 309.39 FEET TO THE POINT OF TANGENCY; THENCE NORTH 77°59'03" EAST, A DISTANCE OF 143.87 FEET TO A POINT ON THE ARC OF A CURVE CONCAVE TO THE EAST HAVING A RADIUS OF 770.00 FEET FROM WHICH A RADIAL LINE BEARS SOUTH 89°37'24" EAST; THENCE SOUTHERLY ALONG THE ARC OF SAID CURVE THROUGH A CENTRAL ANGLE OF 28°53'08" AN ARC DISTANCE OF 381.31 FEET; THENCE SOUTH 77°59'03" WEST, A DISTANCE OF 189.35 FEET TO THE POINT OF CURVATURE OF A CURVE CONCAVE TO THE SOUTHWEST HAVING A RADIUS OF 235.00 FEET; THENCE WESTERLY ALONG THE ARC OF SAID CURVE THROUGH A CENTRAL ANGLE OF 28°52'32" AN ARC DISTANCE OF 122.54 FEET TO THE POINT OF TANGENCY; THENCE SOUTH 48°03'31" WEST, A DISTANCE OF 411.78 FEET TO THE POINT OF CURVATURE OF A CURVE CONCAVE TO THE NORTHWEST HAVING A RADIUS OF 480.00 FEET; THENCE SOUTHWESTERLY ALONG THE ARC OF SAID CURVE THROUGH A CENTRAL ANGLE OF 25°10'39" AN ARC DISTANCE OF 204.34 FEET TO THE POINT OF TANGENCY; THENCE SOUTH 73°14'10" WEST, A DISTANCE OF 189.39 FEET TO THE POINT OF CURVATURE OF A CURVE CONCAVE TO THE SOUTHWEST HAVING A RADIUS OF 200.00 FEET; THENCE WESTERLY ALONG THE ARC OF SAID CURVE THROUGH A CENTRAL ANGLE OF 33°28'13" AN ARC DISTANCE OF 116.83 FEET TO THE POINT OF REVERSE CURVATURE OF A CURVE CONCAVE TO THE NORTHWEST HAVING A RADIUS OF 198.00 FEET; THENCE SOUTHWESTERLY ALONG THE ARC OF SAID CURVE THROUGH A CENTRAL ANGLE OF 33°28'13" AN ARC DISTANCE OF 115.66 FEET TO THE POINT OF TANGENCY; THENCE SOUTH 73°14'10" WEST, A DISTANCE OF 141.74 FEET TO THE POINT OF BEGINNING.

CONTAINING 5'2,328.25 SQUARE FEET OR 11.78 ACRES, MORE OR LESS.

HAVE CAUSED THE SAME TO BE SURVEYED AND PLATTED AS SHOWN HEREON AND DO HEREBY DEDICATE AS FOLLOWS:

- TRACT A, AS SHOWN HEREON, IS HEREBY DEDICATED TO PARADISIO AT MIRASOL PROPERTY OWNERS ASSOCIATION, INC., ITS SUCCESSORS AND ASSIGNS, FOR PRIVATE STREET, DRAINAGE, UTILITY AND OTHER PURPOSES NOT INCONSISTENT WITH THIS DEDICATION AND IS THE PERPETUAL MAINTENANCE OBLIGATION OF SAID ASSOCIATION, ITS SUCCESSORS AND ASSIGNS, WITHOUT RECOURSE TO THE CITY OF PALM BEACH GARDENS AND WITHOUT RECOURSE TO NORTHERN PALM BEACH COUNTY IMPROVEMENT DISTRICT.
- TRACTS B AND C, AS SHOWN HEREON, ARE HEREBY RESERVED FOR PARADISIO AT MIRASOL PROPERTY OWNERS ASSOCIATION, INC., A FLORIDA CORPORATION, NOT FOR PROFIT, ITS SUCCESSORS AND ASSIGNS, FOR OPEN SPACE, LANDSCAPING AND SIGNAGE PURPOSES AND ARE THE PERPETUAL MAINTENANCE OBLIGATION OF SAID ASSOCIATION, ITS SUCCESSORS AND ASSIGNS, WITHOUT RECOURSE TO THE CITY OF PALM BEACH GARDENS.
- THE UTILITY EASEMENTS, AS SHOWN HEREON, ARE HEREBY DEDICATED IN PERPETUITY FOR THE CONSTRUCTION AND MAINTENANCE OF PUBLIC UTILITY FACILITIES, INCLUDING CABLE TELEVISION SYSTEMS, THE INSTALLATION OF CABLE TELEVISION SYSTEMS SHALL NOT INTERFERE WITH THE CONSTRUCTION AND MAINTENANCE OF OTHER PUBLIC UTILITIES.
- THE PEDESTRIAN ACCESS EASEMENT, AS SHOWN HEREON, IS DEDICATED TO MIRASOL MASTER MAINTENANCE ASSOCIATION, INC., A FLORIDA CORPORATION, NOT FOR PROFIT, ITS SUCCESSORS AND ASSIGNS, FOR PEDESTRIAN ACCESS PURPOSES AND IS THE PERPETUAL MAINTENANCE OBLIGATION OF SAID ASSOCIATION, ITS SUCCESSORS AND ASSIGNS, WITHOUT RECOURSE TO THE CITY OF PALM BEACH GARDENS.

MIRASOL PARCEL FOUR

PART OF GOLF DIGEST P.C.D.
SECTIONS 4 AND 5, TOWNSHIP 42 SOUTH, RANGE 42 EAST,
CITY OF PALM BEACH GARDENS,
PALM BEACH COUNTY, FLORIDA
NOVEMBER, 2000 SHEET 1 OF 4

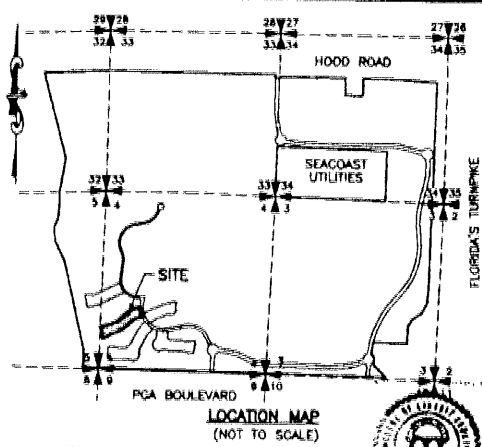

LOCATION MAP (NOT TO SCALE)

STATE OF FLORIDA
COUNTY OF PALM BEACH
THIS PLAT WAS FILED FOR RECORD ON 23rd DAY OF December AD, 2000 AND WAS RECORDED IN PLAT BOOK 317 ON PAGES 17 & 18
BY: DOROTHY H. WILKINSON, D.C.
CIRCUIT COURT SEAL

ACCEPTANCE OF RESERVATIONS

STATE OF FLORIDA)
COUNTY OF PALM BEACH)
MIRASOL MASTER MAINTENANCE ASSOCIATION, INC., A FLORIDA CORPORATION, NOT FOR PROFIT, HEREBY ACCEPTS THE DEDICATIONS OR RESERVATIONS TO SAID ASSOCIATION AS STATED AND SHOWN HEREON, AND HEREBY ACCEPTS ITS MAINTENANCE OBLIGATIONS FOR SAME AS STATED HEREON, DATED THIS 21st DAY OF December, 2000.
MIRASOL MASTER MAINTENANCE ASSOCIATION, INC. A FLORIDA CORPORATION, NOT FOR PROFIT
WITNESS: Gina V. Garcia BY: Carol Guld, City Clerk
PRINT NAME: Gina V. Garcia PRINT NAME: Carol A. Perna, President
WITNESS: Joseph B. Burtch PRINT NAME: Joseph B. Burtch

APPROVALS

CITY OF PALM BEACH GARDENS
COUNTY OF PALM BEACH, FLORIDA
THIS PLAT IS HEREBY APPROVED FOR RECORD DATED THIS 21st DAY OF December, 2000.
ATTEST: Carol Guld, City Clerk BY: Joseph R. Russo, Mayor
CITY ENGINEER: Lenhart E. Lindmark, P.E., City Engineer
THIS PLAT IS HEREBY ACCEPTED FOR RECORD DATED THIS 21st DAY OF December, 2000.
BY: Lenhart E. Lindmark, P.E., City Engineer

ACKNOWLEDGEMENT

STATE OF FLORIDA)
COUNTY OF PALM BEACH)
BEFORE ME PERSONALLY APPEARED John R. Peshkin, WHO IS PERSONALLY KNOWN TO ME, OR HAS PRODUCED John R. Peshkin AS IDENTIFICATION, AND WHO EXECUTED THE FOREGOING INSTRUMENT AS PRESIDENT OF MIRASOL MASTER MAINTENANCE ASSOCIATION, INC., A FLORIDA CORPORATION, NOT FOR PROFIT, AND SEVERALLY ACKNOWLEDGED TO AND BEFORE ME THAT HE EXECUTED SUCH INSTRUMENT AS SUCH OFFICER OF SAID CORPORATION, AND THAT THE SEAL AFFIXED TO THE FOREGOING INSTRUMENT IS THE CORPORATE SEAL OF SAID CORPORATION AND THAT IT WAS AFFIXED TO SAID INSTRUMENT BY DUE AND REGULAR CORPORATE AUTHORITY.
WITNESS MY HAND AND OFFICIAL SEAL THIS 21st DAY OF December, 2000.
MY COMMISSION EXPIRES: 1/1/2007 DATE NOTARY PUBLIC

IN WITNESS WHEREOF, TWC/MIRASOL, INC., A FLORIDA CORPORATION, AS GENERAL PARTNER OF TAYLOR WOODROW COMMUNITIES AT MIRASOL, LTD., A FLORIDA LIMITED PARTNERSHIP, HAS CAUSED THESE PRESENTS TO BE SIGNED BY ITS PRESIDENT AND ITS CORPORATE SEAL TO BE AFFIXED HEREBY BY AND WITH THE AUTHORITY OF ITS BOARD OF DIRECTORS, THIS 21st DAY OF November, 2000.

TAYLOR WOODROW COMMUNITIES AT MIRASOL, LTD.,
A FLORIDA LIMITED PARTNERSHIP, 1/1/0 TWC/GOLF DIGEST, LTD.
BY: TWC/MIRASOL, INC., A FLORIDA CORPORATION,
1/1/0 TWC JOB GOLF VENTURES, INC.,
AS GENERAL PARTNER OF TAYLOR WOODROW COMMUNITIES AT MIRASOL, LTD.

WITNESS: Raedyn E. Funcher, John R. Peshkin
PRINT NAME: Raedyn E. Funcher, PRINT NAME: John R. Peshkin
WITNESS: Danielle LaFrance, President
PRINT NAME: Danielle LaFrance

ACKNOWLEDGEMENT
STATE OF FLORIDA)
COUNTY OF SARASOTA)
BEFORE ME PERSONALLY APPEARED John R. Peshkin, WHO IS PERSONALLY KNOWN TO ME, OR HAS PRODUCED John R. Peshkin AS IDENTIFICATION, AND WHO EXECUTED THE FOREGOING INSTRUMENT AS THE PRESIDENT OF TWC/MIRASOL, INC., A FLORIDA CORPORATION, AS GENERAL PARTNER OF TAYLOR WOODROW COMMUNITIES AT MIRASOL, LTD., A FLORIDA LIMITED PARTNERSHIP, AND SEVERALLY ACKNOWLEDGED TO AND BEFORE ME THAT HE EXECUTED SUCH INSTRUMENT AS SUCH OFFICER OF SAID CORPORATION, AND THAT THE SEAL AFFIXED TO THE FOREGOING INSTRUMENT IS THE CORPORATE SEAL OF SAID CORPORATION AND THAT IT WAS AFFIXED TO SAID INSTRUMENT BY DUE AND REGULAR CORPORATE AUTHORITY.

WITNESS MY HAND AND OFFICIAL SEAL THIS 30th DAY OF November, 2000.
MY COMMISSION EXPIRES: 4/1/2007 DATE NOTARY PUBLIC

SEAL TWC/MIRASOL, INC. SEAL MIRASOL MASTER MAINTENANCE ASSOCIATION, INC. SEAL CITY OF PALM BEACH GARDENS SEAL REVIEWING SURVEYOR AND MAPPER

NORTHERN PALM BEACH COUNTY IMPROVEMENT DISTRICT LAND USE CLASSIFICATION	CODE
SINGLE FAMILY(OTHER)	SFO
EXEMPT ACREAGE	EXM

P.C.D. TABULAR DATA	LAND USE CODE	LAND USE CODE	LAND USE CODE		
LOT 1	0.20 ACRES	SFO	LOT 26	0.27 ACRES	SFO
LOT 2	0.21 ACRES	SFO	LOT 27	0.27 ACRES	SFO
LOT 3	0.24 ACRES	SFO	LOT 28	0.23 ACRES	SFO
LOT 4	0.24 ACRES	SFO	LOT 29	0.20 ACRES	SFO
LOT 5	0.23 ACRES	SFO	LOT 30	0.20 ACRES	SFO
LOT 6	0.22 ACRES	SFO	LOT 31	0.20 ACRES	SFO
LOT 7	0.20 ACRES	SFO	LOT 32	0.20 ACRES	SFO
LOT 8	0.20 ACRES	SFO	LOT 33	0.24 ACRES	SFO
LOT 9	0.20 ACRES	SFO	LOT 34	0.23 ACRES	SFO
LOT 10	0.20 ACRES	SFO	LOT 35	0.21 ACRES	SFO
LOT 11	0.20 ACRES	SFO	LOT 36	0.20 ACRES	SFO
LOT 12	0.21 ACRES	SFO	LOT 37	0.20 ACRES	SFO
LOT 13	0.23 ACRES	SFO	LOT 38	0.20 ACRES	SFO
LOT 14	0.25 ACRES	SFO	LOT 39	0.20 ACRES	SFO
LOT 15	0.24 ACRES	SFO	LOT 40	0.21 ACRES	SFO
LOT 16	0.21 ACRES	SFO	LOT 41	0.21 ACRES	SFO
LOT 17	0.20 ACRES	SFO	LOT 42	0.22 ACRES	SFO
LOT 18	0.20 ACRES	SFO	LOT 43	0.23 ACRES	SFO
LOT 19	0.20 ACRES	SFO	LOT 44	0.23 ACRES	SFO
LOT 20	0.20 ACRES	SFO	LOT 45	0.21 ACRES	SFO
LOT 21	0.20 ACRES	SFO	LOT 46	0.20 ACRES	SFO
LOT 22	0.20 ACRES	SFO	TRACT A	1.88 ACRES	EXM
LOT 23	0.24 ACRES	SFO	TRACT B	0.19 ACRES	EXM
LOT 24	0.24 ACRES	SFO	TRACT C	0.12 ACRES	EXM
LOT 25	0.21 ACRES	SFO			
TOTAL AREA 11.78 ACRES					

THIS INSTRUMENT WAS PREPARED BY MARY HANNA CLODFELTER, P.S.M. IN THE OFFICES OF MOCK, ROOS & ASSOCIATES, INC., 5720 CORPORATE WAY, WEST PALM BEACH, FLORIDA 33407.

SCALE: N/A
P.A. NO.: 99313.00
DATE: MARCH, 2000
DRAWING NO.: 42-42-04-37
FLORIDA L.B. NO. 48
MOCK ROOS ENGINEERS SURVEYORS PLANNERS
5720 Corporate Way, West Palm Beach, Florida 33407
(561) 863-3113, fax 478-7248

MIRASOL PARCEL FOUR
PART OF GOLF DIGEST P.C.D.
SITUATE IN SECTIONS 4 AND 5,
TOWNSHIP 42 SOUTH, RANGE 42 EAST,
CITY OF PALM BEACH GARDENS,
PALM BEACH COUNTY, FLORIDA